

Orgaflex

This flexible paper conductor with foil core has a high mechanical strength. It can be cemented into conductor holes or used with flanges. Useful for winding facade pipes and small actions. Available by coil or cut lengths.

	I.D.	Drill Size for O.D.	Coil Length
4010.01	1/2"	5/8"	50'
4010.02	3/4"	15/16"	50'
4010.03	1"	1-3/16"	25'
4010.04	1-1/4"	1-7/16"	25'
4010.05	1-1/2"	1-11/16"	25'
4010.06	2"	2-1/4"	25'
4010.07	2-1/2"	2-11/16"	25'
4010.08	3"	3-3/16"	25'
4010.09	4"		25'
4010.11	6"		10'



Orgaduct

Orgaduct is a high grade, wire-reinforced conductor with a light weight elastomeric covering. Flexible over wide temperature range, it is also resistant to ozone and abrasion. Available by 12' or 6' lengths.

	I.D.	Coil Length
4020.04	1-1/4"	12'
4020.06	2"	12'
4020.07	2-1/2"	12'
4020.08	3"	12'
4020.09	4"	12'
4020.11	6"	12'



Flexduct

Flame retardant Flexduct is a bonded PVC/polyester fabric conductor with integral strength. Sizes up to 8" Ø are single ply, 10" and 12" use heavy duty, bonded double fabric for added strength. Available in coil or cut lengths.



	I.D.	Coil Length
4025.08	3"	25'
4025.09	4"	25'
4025.10	5"	25'
4025.11	6"	25'
4025.12	8"	25'
4025.14	10"	25'
4025.15	12"	25'

Flexaust

Very high grade Flexaust is a wire reinforced, fabric-covered conductor. This is the most rugged of the flexible conductors. 10" and 12" are heavy duty, double fabric. Available by coil or cut lengths.



	I.D.	Coil Length
4030.06	2"	25'
4030.07	2-1/2"	25'
4030.08	3"	25'
4030.09	4"	25'
4030.10	5"	25'
4030.11	6"	25'
4030.12	8"	25'
4030.14	10"	25'
4030.15	12"	25'

Cast Flanges

Cast aluminum flanges are designed for use with all of the flexible wind conductors. Use with 4060.00 series cork gaskets. Screw holes for No. 6 screws on 1" to 3" Ø flanges, all other flanges use No. 8 mounting screws.

	Size	Flange I.D.	Collar O.D.
4040.03	1"	3/4"	2-1/16"
4040.04	1-1/4"	1"	2-1/4"
4040.05	1-1/2"	1-1/4"	2-9/16"
4040.06	2"	1-5/8"	3-1/8"
4040.07	2-1/2"	2-3/16"	3-3/4"
4040.08	3"	2-9/16"	4-1/4"
4040.09	4"	3-5/8"	5-5/16"
4040.10	5"	4-9/16"	6-1/2"
4040.11	6"	5-3/8"	7-5/8"
4040.12	8"	7-3/8"	10-1/8"
4040.13	8" oval	8-9/16" x 5-1/16"	10-7/8" x 7-5/16"
4040.14	10"	9-7/16"	12"
4040.15	12"	11-1/4"	14"



Clamps

Made from rust-free stainless steel.

1/2" W

Size

4070.05	1" to 1-1/2"
4070.06	2"
4070.07	2-1/2"
4070.08	3"
4070.09	4"
4070.10	5"
4070.11	6"
4070.12	8"
4070.14	10"
4070.15	12"
4070.16	15"



Cork Gaskets

These 3/32" cork gaskets are designed for use with cast flanges.

	Size	I.D.	O.D.
4060.03	1"	1"	2"
4060.04	1-1/4"	1-1/4"	2-1/4"
4060.05	1-1/2"	1-1/2"	2-1/2"
4060.06	2"	2"	3"
4060.07	2-1/2"	2-1/2"	3-5/8"
4060.08	3"	2-3/4"	4-1/2"
4060.09	4"	3-3/4"	5-3/8"
4060.10	5"	4-3/4"	6-1/2"
4060.11	6"	5-3/8"	7-5/8"
4060.12	8"	8"	10"
4060.13	8" oval	5-3/4" x 9-3/8"	7-1/4" x 10-7/8"
4060.14	10"	9-1/2"	12"
4060.15	12"	11-7/8"	14"

Felt Clamp Liners

Gray felt strip used between clamp and flexible conductor or wind sleeve for air tight seal.

3/4" W x 1/8" T

Size

4080.03	1"
4080.04	1-1/4"
4080.05	1-1/2"
4080.06	2"
4080.07	2-1/2"
4080.08	3"
4080.09	4"
4080.10	5"
4080.11	6"
4080.12	8"
4080.14	10"
4080.15	12"



PVC WINDING SYSTEMS

The PVC pipe winding system components incorporate the best materials from the piping industry and have been selected specifically for organ winding. Both *S-40* (Schedule 40) and *Lite Pipe* systems include all male and female flanges and all commonly used components for 2", 3", 4", and 6" wind lines.

S-40 pipe and components are heavy duty, rigid materials. The tubing wall is 15/64" thick.

Lite Pipe components are 1/4 to 1/2 the weight of *S-40* materials and are an inexpensive alternative. With a wall thickness of 5/64" and lighter component weight, this system is more self supporting. *Lite Pipe* has one male and one female end on each length of pipe, eliminating use of in-line connectors.

Both *S-40* and *Lite Pipe* can be easily cut and fabricated with hand tools. Standard PVC solvent adhesive used for bonding. Can be painted with readily available latex based paints. The drawings illustrate some of the many applications of *S-40* and *Lite Pipe* components.

S-40 and *Lite Pipe* components are **not** interchangeable.

S-40

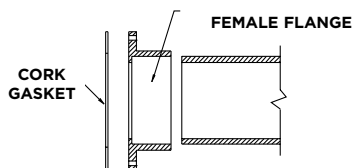

EXAMPLE #1

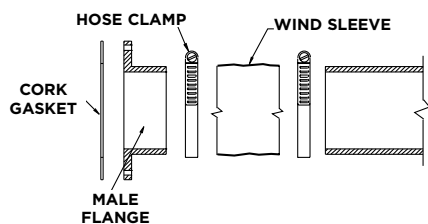

EXAMPLE #2

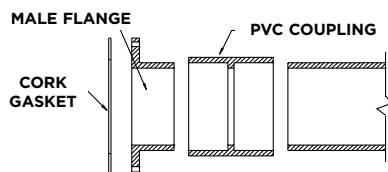

EXAMPLE #3

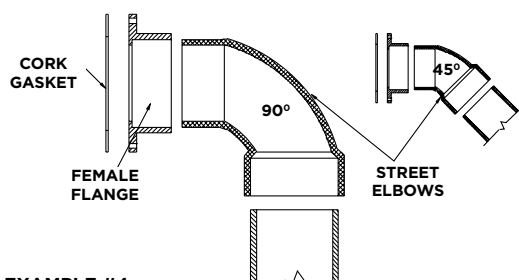

EXAMPLE #4

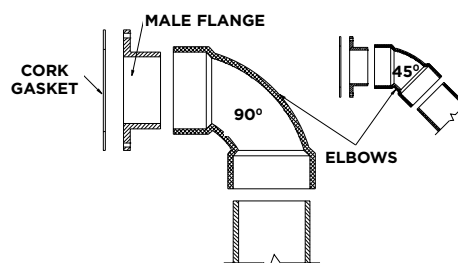

EXAMPLE #5

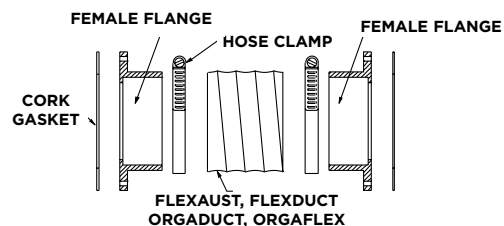

EXAMPLE #6

Lite Pipe

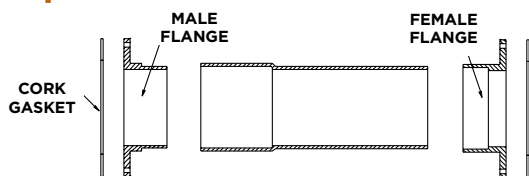

EXAMPLE #7

PVC Flanges

PVC flanges are available in both female and male configurations for *S-40* and *Lite Pipe* applications. Flanges may be joined to tubing, flexible conductors, or wind sleeves. Use No. 8 Washer Head screws listed below for mounting. With wind sleeves, select *S-40* or *Lite Pipe* male flanges. For flexible wind conductors, select appropriate 4040.00 series cast aluminum flanges.

		<i>Lite Pipe</i>			
Size		A	B	C	D
4045.38	3" Male	3-1/16"	3-1/4"	5-1/2"	1-11/16"
4045.48	3" Female	3-1/4"	3-1/2"	5-1/2"	1-11/16"
4045.39	4" Male	4-1/16"	4-1/4"	6-1/2"	1-11/16"
4045.49	4" Female	4-1/4"	4-1/2"	6-1/2"	1-11/16"
4045.21	6" Female	6-5/16"	6-11/16"	8-1/8"	2-7/16"

S - 40

Size		A	B	C	D
4045.06	2" Male	2-1/16"	2-3/8"	4"	1-1/2"
4045.16	2" Female	2-3/8"	2-15/16"	4"	1-1/2"
4045.08	3" Male	3-1/16"	3-1/2"	5-1/2"	1-11/16"
4045.18	3" Female	3-1/2"	3-15/16"	5-1/2"	1-11/16"
4045.09	4" Male	4-1/16"	4-1/2"	6-1/2"	1-11/16"
4045.19	4" Female	4-1/2"	4-15/16"	6-1/2"	1-11/16"

7608.55 No. 8 x 3/4" Hex Washer Head Slotted Mounting Screws

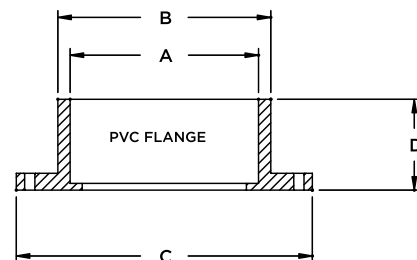

Cork Gasket

These 3/32" cork gaskets are sized for use with the PVC flanges.

Size	I.D.	O.D.
4061.02	2"	2-3/8"
4060.09	3"	3-3/4"
4060.10	4"	4-3/4"
4061.06	6"	6-3/8"

Pipe

PVC *S-40* pipe has male ends. *Lite Pipe* has one male and one female end. Both are shipped in 10' lengths. Truck shipment only.

<i>Lite Pipe</i>	<i>S-40</i>	Size
	4043.02	2"
4043.13	4043.03	3"
4043.14	4043.04	4"
4043.16	4043.06	6"



Tee, Sanitary

Lite Pipe	S-40	Size
	4044.02	2"
4044.13	4044.03	3"
4044.14	4044.04	4"
4044.16	4044.06	6"

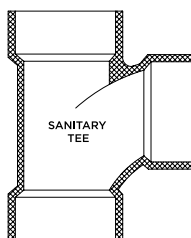
**Wye**

Lite Pipe	S-40	Size
	4048.02	2"
4048.13	4048.03	3"
4048.14	4048.04	4"
4048.16	4048.06	6"

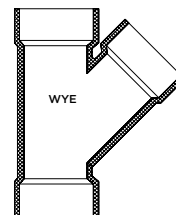
**Elbow, 90°**

Lite Pipe	S-40	Size
	4046.02	2"
4046.13	4046.03	3"
4046.14	4046.04	4"
4046.16	4046.06	6"

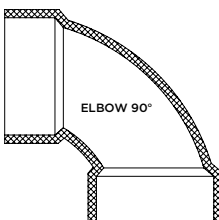
**Wye, Reducing**

Lite Pipe	S-40	Size
	4048.07	3" to 2"
	4048.08	4" to 3"

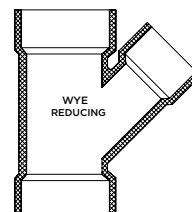
**Elbow, 90° Street**

Lite Pipe	S-40	Size
	4046.22	2"
4046.33	4046.23	3"
4046.34	4046.24	4"
4046.36	4046.26	6"

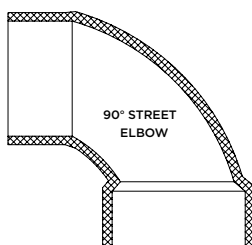
**Coupling, Female**

Lite Pipe	S-40	Size
	4049.02	2"
4049.13	4049.03	3"
4049.14	4049.04	4"
4049.16	4049.06	6"

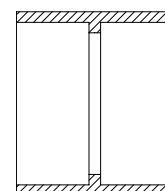
**Elbow, 45°**

Lite Pipe	S-40	Size
	4047.02	2"
4047.13	4047.03	3"
4047.14	4047.04	4"
4047.16	4047.06	6"

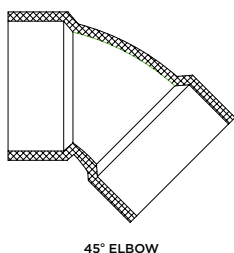
**Reducer, Female**

Lite Pipe	S-40	Size
	4049.27	3" to 2"
4049.38	4049.28	4" to 3"
4049.39		6" to 4"

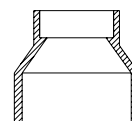
**Elbow, 45° Street**

Lite Pipe	S-40	Size
	4047.22	2"
4047.33	4047.23	3"
4047.34	4047.24	4"
4047.36	4047.26	6"

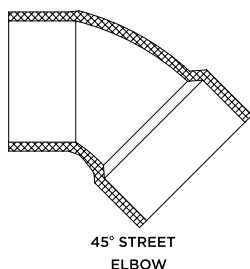
**Lite Pipe to S-40 Adapter**

Lite Pipe	S-40	Size
4049.44		4" Lite Pipe to 3" S-40

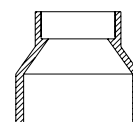

Galvanized Conductors

10' standard length, 26 gauge. Seam not soldered. Shipped by truck only.

Size

4100.06	2"
4100.08	3"
4100.09	4"
4100.10	5"
4100.11	6"

Galvanized Elbows, 90°

Non-adjustable, 26 gauge. Seams not soldered.

Size

4110.06	2"
4110.08	3"
4110.09	4"
4110.10	5"
4110.11	6"

Lead Tubing

Available in 50 ft. coil or 70 lb. reel.

	Package	I.D.	O.D.	Ft. /Lb.
4300.03	50 ft. coil	3/16"	1/4"	9
4300.05	50 ft. coil	1/4"	5/16"	8
4300.07	50 ft. coil	5/16"	3/8"	6
4300.10	50 ft. coil	3/8"	7/16"	5
4300.53	70 lb. reel	3/16"	1/4"	9
4300.55	70 lb. reel	1/4"	5/16"	8
4300.57	70 lb. reel	5/16"	3/8"	6
4300.60	70 lb. reel	3/8"	7/16"	5

Wind Sleeves

Flexible rubber cloth wind connections for conductors, blowers, etc. 28" long. Custom sizes available. Shorter lengths of 7", 14", or 21" are in stock.

Size Application

4200.08	3"	Galvanized
4200.09	4"	Galvanized
4200.11	6"	Galvanized
4200.07	7"	Galvanized
4200.12	8"	Galvanized
4200.14	10"	Galvanized
4200.15	12"	Galvanized
4200.17	14"	Galvanized
4200.16	15"	Galvanized
4200.26	2-3/8"	S-40
4200.28	3-1/2"	S-40
4200.29	4-1/2"	S-40
4200.31	6-5/8"	S-40
4200.38	3-1/4"	Lite Pipe
4200.39	4-1/4"	Lite Pipe
4200.41	6-1/4"	Lite Pipe
4201.00	Special size	

Neoprene Tubing

Supplied in coils or cut lengths.

I.D. O.D. Length

4400.01	1/8"	7/32"	100'
4400.02	11/64"	1/4"	100'
4400.03	3/16"	5/16"	100'
4400.04	7/32"	5/16"	100'
4400.05	1/4"	3/8"	100'
4400.06	9/32"	3/8"	100'
4400.07	5/16"	7/16"	100'
4400.08	11/32"	1/2"	100'
4400.09	13/32"	9/16"	100'
4400.10	15/32"	5/8"	100'
4400.11	15/32"	11/16"	100'

