

## Swell Shutter Assembly

- 3000.00** Solid swell shutters are made from glued up 1-1/2" x 1-3/4" basswood stock. Frame is 1-1/2" thick basswood, 6" wide. Vertical and horizontal shutters are mounted on ball bearings, double felted for quiet operation and easy removal. Shutter blades over 8' long require center support. Shade dogs attach to 7/8" x 2" hardwood trace rod with screws. Flat black is standard finish. Special finishes are available. Designate Style No. 1 or No. 2 and trace location. Custom-built swell shutters of thicker material, with hardwood veneer, special edge design or special shade dogs to keep trace within shade arc are constructed to specifications and drawings.

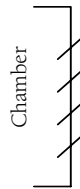

STYLE NO. 1

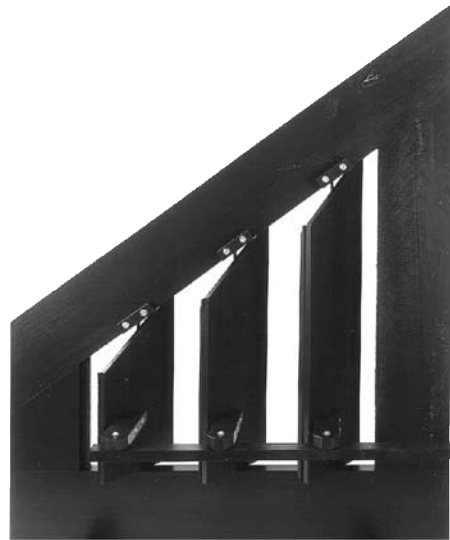

STYLE NO. 2

HORIZONTAL SHADES  
SIDE VIEW

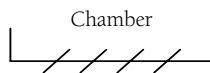
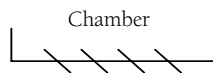

VERTICAL SHADES  
TOP VIEW

## Shade Dogs

- 3001.00** Shade Dogs (Goosenecks) mount on swell shade and connect with shade trace. Mounting hardware provided. Hole bushed for 3/16" Ø pin or No. 10 wood screw.

7/8" T x 2" W x 6-5/8" L O.A.



## Swell Box

- 3200.00** Swell box is manufactured to drawings and specifications. Boxes are constructed of 3/4" plywood or 1" MDF.

## Swell Shutter Pins

	Used	Size	Type Shade	Use with Bearing
<b>3300.01</b>	Bottom	1/4" Ø (3/8" Ø) x 2-1/4"	Vertical	3310.01
<b>3300.02</b>	Top	1/4" Ø x 3-1/4"	Vertical	
<b>3300.03</b>	Ends	3/8" Ø x 3-1/4"	Horizontal	3310.02



## Ball Bearings

	I.D.	O.D.	Thick	Use
<b>3310.01</b>	1/4"	7/8"	1/4"	Bottom Vertical Shade
<b>3310.02</b>	3/8"	15/16"	5/16"	Horizontal Shade



## Swell Shutter Spring

.035" steel wire with loop ends.

	O.D.	Coil Length	O.A. Length	Opens To
<b>7250.04</b>	1/2"	4"	4-3/4"	15"
<b>7250.05</b>	1/2"	8"	8-3/4"	30"



## Unenclosed Swell Motor

Power stroke derived by energizing magnets and inflating bags (push). Speed is adjustable on first two stages. 3" Ø inlet.

Stages	Without Stand					Shipping Weight
	L	x	D	x	H	
3400.05	5	10-1/2"	11-3/4"	26-1/2"	34 lbs.	
3400.08	8	15"	11-3/4"	26-1/2"	45 lbs.	

### Floor Stand

Unassembled floorstands are available for both 5 and 8 stage swell motors. The dimensions listed are for the swell motor with legs installed.

Stages	With Stand				
	L	x	D	x	H
3401.05	5	18-3/4"	11-3/4"	28-7/8"	
3401.08	8	24"	11-3/4"	28-7/8"	

3400.51 Replacement rubber cloth bags, complete with mounting block, ready for installation.

17" L x 11-3/4" W x 1" T



## Enclosed Swell Motor

3408.00 8-stage, power stroke action is generated by de-energizing magnets and exhausting accordion bellows (pull). Stages are graduated. Speed is adjustable on first two stages via primary valve travel. No inlet provided. 6" stroke, will operate as low as 3" WP.

26-1/2" L x 25" H x 17-3/8" D  
Shipping Weight: 75 lbs.

3408.01 Secondary muffler (not illustrated) encloses magnets and primaries for quieter operation.



### Servo Shoe Potentiometer and Linkage

- 3411.00** 1k OHM Linear Potentiometer mounted on aluminum angle brackets for solid state swell expression or crescendo. 11 Gauge phosphor bronze connecting rod and shoe attachment plate included.



### Aluminum Swell Arm

- 3501.00** For 3/4" I.D. iron pipe.

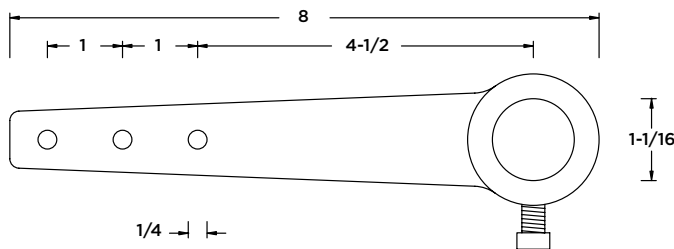

### Swell Roller Assembly

- 3502.00** Adjustable, ball bearing mounted, with two 3501.00 arms and threaded brass connecting rods.
- 10-5/8" H x 10" W x 4" D without arms.

